



## Pattern I-spy

Welcome to Rochester Cathedral. See if you can spot where these photos were taken. The location of each picture is shown on the plan.

Rochester  
CATHEDRAL

Name \_\_\_\_\_

1. Letting in the light is very important. What are the shapes that look like diamonds called? \_\_\_\_\_

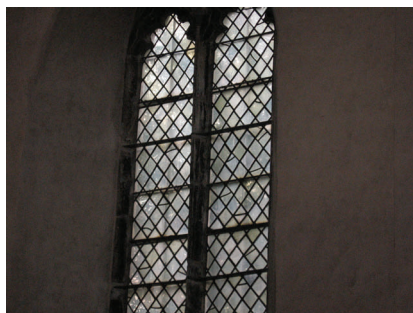

I have spotted this.

2. This is near the top of a Gothic (pointed) arch.



I have spotted this.

3. One of our beautiful ceiling patterns.  
Watch out for more as you go around the Cathedral.



I have spotted this.

The numbers on this plan will help you find the right places.

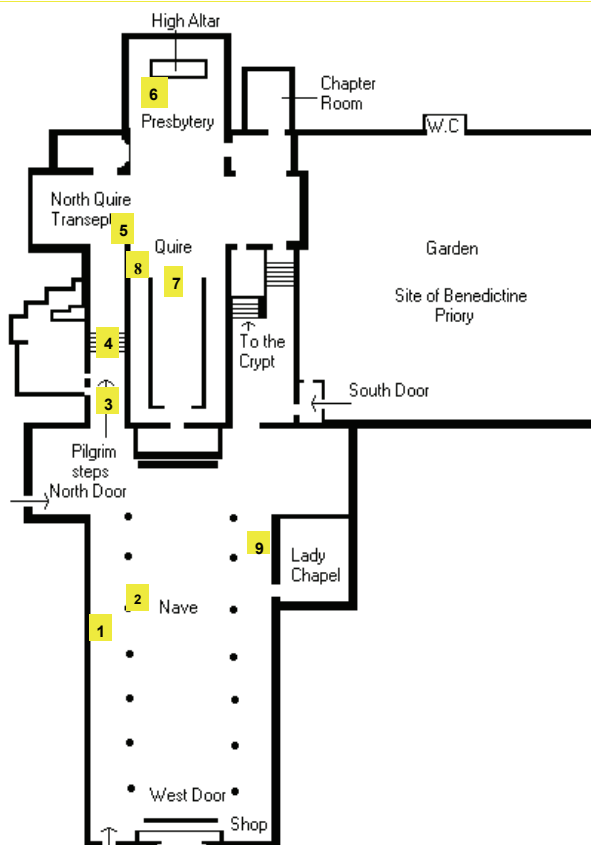

4. Pilgrims used to go up these stairs ... on their knees!



I have spotted this.

5. This is one of our floor patterns. Look out for many more as you go around the Cathedral. There is a tomb nearby ... whose?



I have spotted this.

6. Here is part of our altar rail. Is it nice and shiny today? Do you know what it is made of?



I have spotted this.

7. This pattern leads through the Quire where the choir sing.



I have spotted this.

8. Here are lions (for England) and fleurs de lys (for France). Do you have any walls decorated like this at home?



I have spotted this.

9. These beautiful pipes are on our chamber organ.



I have spotted this.

10. After spotting all these patterns today, here is some space to copy another pattern from the Cathedral.

You can design your own pattern if you like.